

PERSPECTIVE VIEW



HIG-3 BHK SITE PLAN



TOTAL SITE AREA = 16212.95 SQ.M. (174514.74 SQ.FT.)

TOTAL NO. OF UNITS = 338

TOTAL BUILT-UP AREA = 45360.65 SQ.M. (488257.97 SQ.FT.)

HIG-3 BHK UNIT PLAN-A

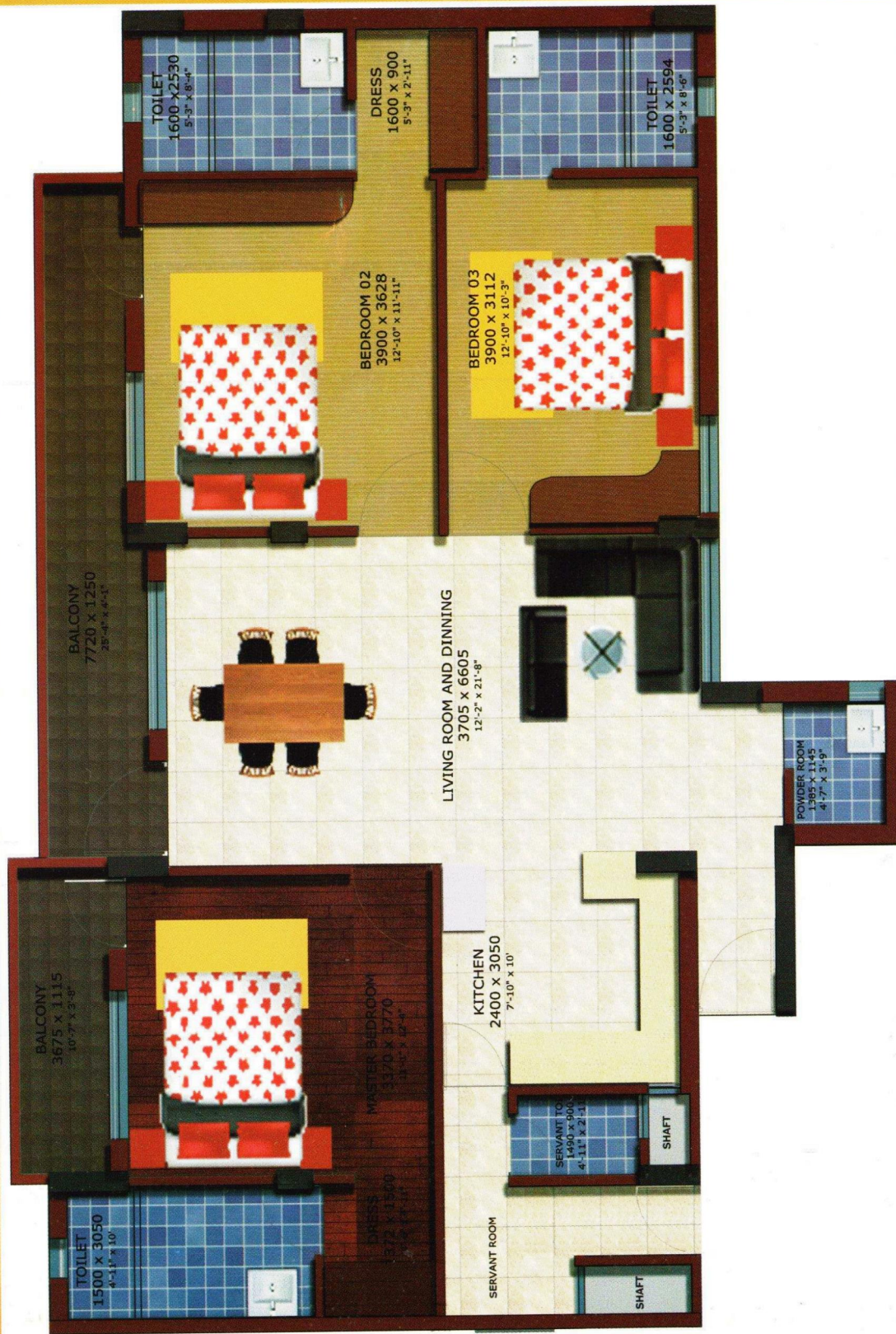

Kitchen, Living room cum Dining room, 2 Bedrooms with attached Toilet & Dress, 1 Bedroom with attached Toilet, 2 Balconies, 1 Powder room, 1 Servant room with attached toilet, Lifts, Parking Facility, USPs:- Swimming pool, Green Court, Health Club- GYM, Game room, Meditation/Yoga, Recreational activities- 2 Party halls, Departmental Store, Café/Lounge, COVERED AREA= 1388.Sq. Ft. (with balcony) SUPER AREA = 1954.00 Sq. Ft.

HIG-3 BHK UNIT PLAN-B

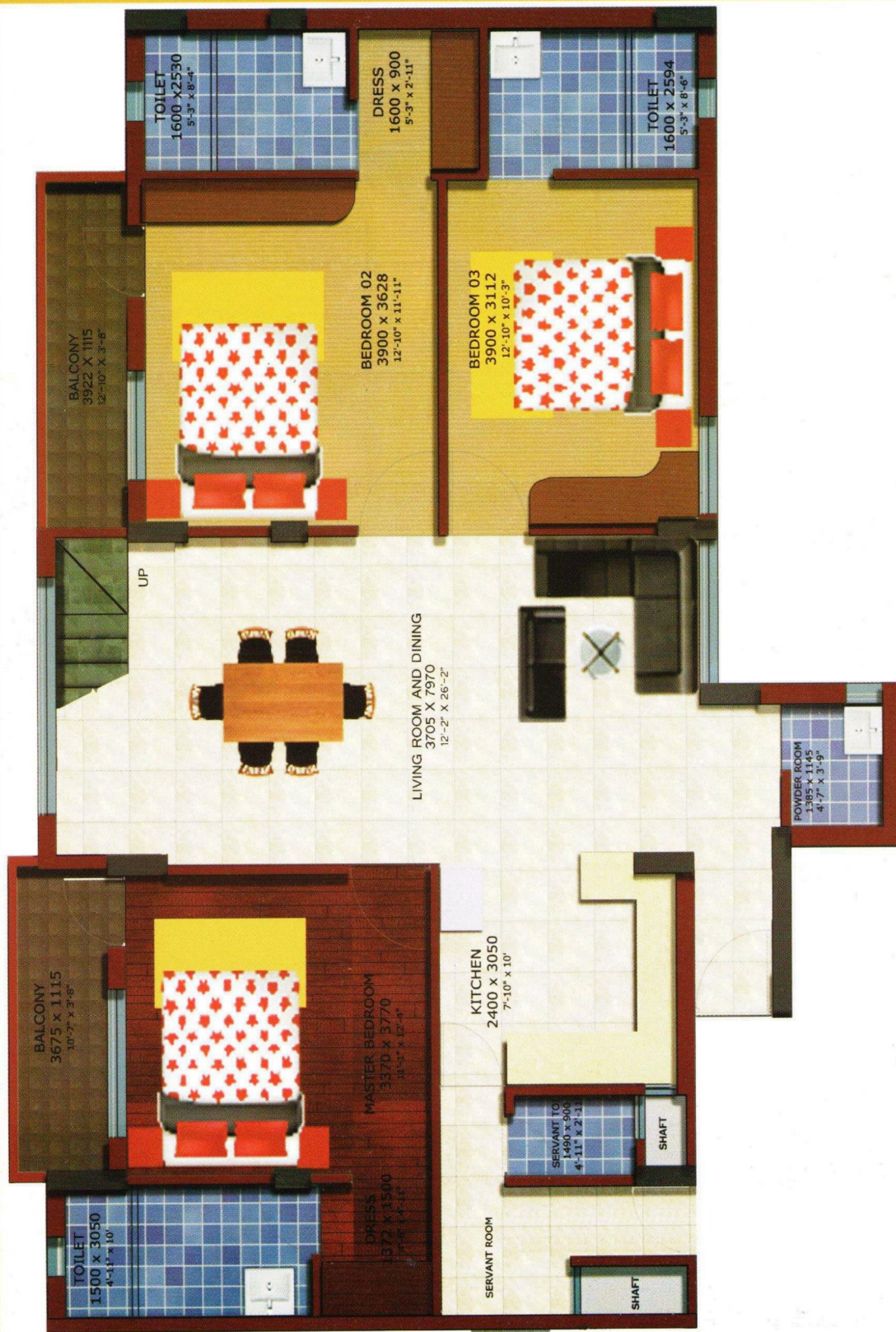

Kitchen, Living room cum Dining room, 2 Bedrooms with attached Toilet & Dress, 1 Bedroom with attached Toilet, 2 Balconies, 1 Powder room, 1 Servant room with attached toilet, Terrace, Lifts, Parking Facility, USPs:- Swimming pool, Green Court, Health Club- GYM, Game room, Meditation/Yoga, Recreational activities- 2 Party halls, Departmental Store, Café/Lounge
COVERED AREA = 1558.30 Sq. Ft. (with balcony) SUPER AREA = 3280.00 Sq. Ft.

TERRACE



CLUB AREA (FIRST FLOOR)



CLUB AREA (SECOND FLOOR)





***World Class Transport Facility at door step.
(PRTS Junction Proposed at Project Site.)***

MIG-2 BHK PRESPECTIVE VIEW



MIG-2 BHK UNIT PLAN





www.mddaonline.com

मसूरी देहरादून विकास प्राधिकरण

सहारनपुर रोड, ट्रांसपोर्ट नगर, देहरादून।

"पहले आओ पहले पाओ" योजना के अन्तर्गत
एच.आई.जी. एवं एम.आई.जी. प्लैट का विवरण

(PAYMENT PLAN)

S. NO.	SCHEME NAME	CATEGORY OF FLAT	COST OF FLAT	AREA OF FLAT	PAYMENT PLAN
1	<u>MDDA ISBT HOUSING SCHEME</u>	HIG TYPE A	71,50,000 /-	Covered Area=1388 sq. ft. Super Area = 1954 sq.ft.	<ul style="list-style-type: none">• Booking Amount 10% of total cost• After Allotment 15% of total cost• Within six month 50% of total cost• Remaining on possession
2	<u>MDDA ISBT HOUSING SCHEME</u>	HIG TYPE B	79,20,000 /-	Covered Area=1558.30 sq. ft. Super Area =3280 sq. ft.	<ul style="list-style-type: none">• Booking Amount 10% of total cost• After Allotment 15% of total cost• Within six month 50% of total cost• Remaining on possession
3	<u>MDDA ISBT EXTENTION HOUSING SCHEME</u>	MIG	49,50,000/-	Covered Area= 918.4 sq. ft. Super Area = 1506.3 sq.ft.	<ul style="list-style-type: none">• Booking Amount 10% of Total Cost• Remaining On Possession